

SF-DRC (Cutting Depth: 8xD)

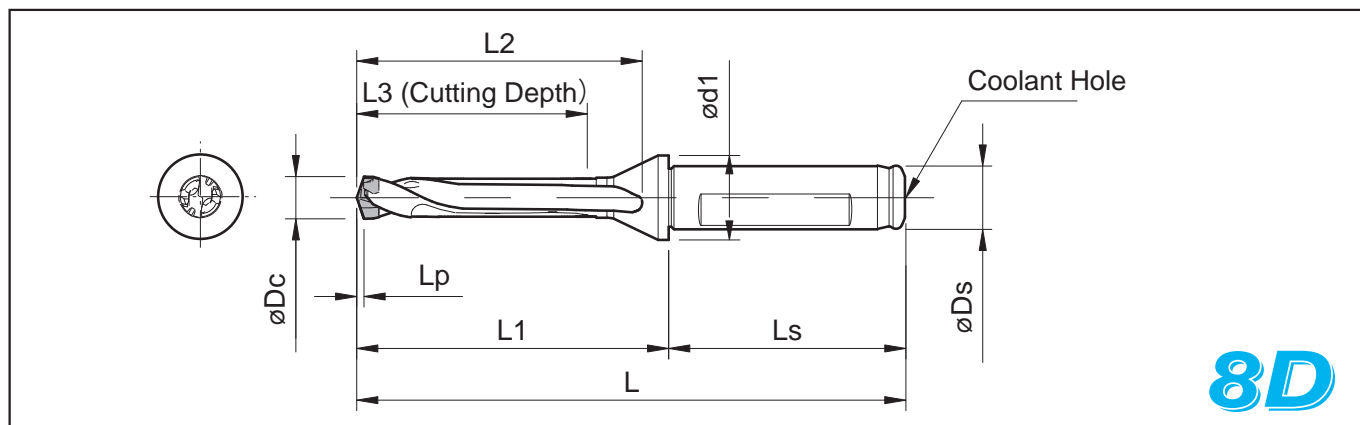

· For Lp, indicates distance from drill point to corner edge, see [K4~K6](#)

● Toolholder Dimension

Description	Std.	Dimensions (mm)									Spare Parts	Applicable Inserts ● K4~K6	
		Applicable Insert Dia. øDc		øDs (h6)	L	L1	L2	L3	Ls	ød1			Wrench see K15
		min.	max.										
SF12- DRC080M-8	●	7.94	8.49	12	129	84	79	68	45	16	WDR8 (WDR17)	DC0794M-SC~DC0840M-SC	
	●	8.50	8.99		134	89	83	72				DC0850M-SC~DC0890M-SC	
	●	9.00	9.49		138	93	88	76				DC0900M-SC~DC0940M-SC	
	●	9.50	9.99		144	99	93	80				DC0950M-SC~DC0990M-SC	
SF16- DRC100M-8	●	10.00	10.49	16	151	103	97	84	48	20	WDR10 (WDR17)	DC1000M-SC~DC1040M-SC	
	●	10.50	10.99		156	108	102	88				DC1050M-SC~DC1090M-SC	
	●	11.00	11.49		160	112	107	92				DC1100M-SC~DC1140M-SC	
	●	11.50	11.99		165	117	111	96				DC1150M-SC~DC1190M-SC	
	●	12.00	12.49		169	121	116	100			WDR12 (WDR17)	DC1200M-SC~DC1240M-SC	
	●	12.50	12.99		174	126	120	104				DC1250M-SC~DC1290M-SC	
	●	13.00	13.49		178	130	124	108				DC1300M-SC~DC1340M-SC	
	●	13.50	13.99		184	136	130	112				DC1350M-SC~DC1390M-SC	
	●	14.00	14.49		188	140	134	116				WDR14 (WDR17)	DC1400M-SC~DC1440M-SC
	●	14.50	14.99		193	145	139	120					DC1450M-SC~DC1490M-SC
SF20- DRC150M-8	●	15.00	15.99	20	204	154	148	128	50	25	WDR17 (WDR17)	DC1500M-SC~DC1580M-SC	
	●	16.00	16.99		213	163	157	136				DC1600M-SC~DC1690M-SC	
	●	17.00	17.99		223	173	167	144				DC1700M-SC~DC1790M-SC	
SF25- DRC180M-8	●	18.00	18.99	25	238	182	176	152	56	32	WDR17	DC1800M-SC~DC1890M-SC	
	●	19.00	19.99		247	191	185	160				DC1900M-SC~DC1990M-SC	
	●	20.00	20.99		256	200	194	168				DC2000M-SC~DC2099M-SC	
	●	21.00	21.99		266	210	204	176				DC2100M-SC~DC2150M-SC	
	●	22.00	22.99		275	219	213	184				DC2200M-SC~DC2250M-SC	
	●	23.00	23.99		284	228	222	192				DC2300M-SC~DC2350M-SC	
	●	24.00	24.99		293	237	231	200				DC2400M-SC~DC2450M-SC	
	●	25.00	25.50		303	247	241	208				DC2500M-SC~DC2550M-SC	

● : Std. Item

