

External Threading Toolholders [TT Insert]

KTT

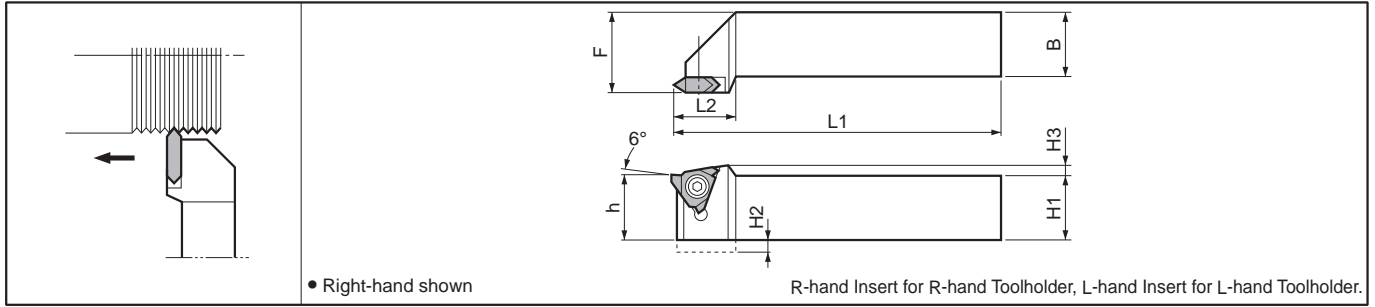

Toolholder Dimensions

Description	Std.		Dimension (mm)							Spare Parts				
	R	L	H1=h	H2	H3	B	L1	L2	F	Clamp Screw		Wrench		
KTT^{R/L} 1010F -16	●	●	10	4		10	80		12	SB-4070TRS	-	FT-10	-	
1212H -16	●	●	12	2		12	100		16					
1616H -16	●	●	16	-	2.5	16	100	18	20					
2020K -16	●	●	20	-		20	125		25	SB-4TR	-	FT-15	-	
2525M -16	●	●	25	-		25	150		30					
2020K -22	●	●	20	-	3.0	20	125	25	25	-	GS-50	-		LW-3
2525M -22	●	●	25	-		25	150		30					

Applicable Inserts

Description	A	T	ød
TT32^{R/L}	9.525	3.18	4.4
TT43^{R/L}	12.70	4.76	5.5

	P Carbon Steel / Alloy Steel	M Stainless Steel	K Cast Iron	N Non-ferrous Metals	Classification of usage
●	○	○	○	○	● : 1st Choice ○ : 2nd Choice

Insert Right-hand Shown	Description	Applicable Thread	Pitch		Dimension (mm)			Angle (°)	Cermet	PVD Coated Carbide	Carbide	Applicable Toolholder	Ref. Page for Depth of Cut & No. of Passes	
			mm	TPI	re	S1	S2							θ
			TC60	PR930	PR1115	KW10								
	TT32^{R/L} 6000	M UN	0.5-2.5	-	56-10	0.0				●	●	KTT^{R/L}...-16	J37	
	6001	M UN	1.0-2.5	-	24-10	0.1			60°	●	●			
	6002	M UN	1.5-2.5	-	16-10	0.2	-	-	60°	●	●			
	6003	M UN	2.5	-	11-10	0.3			60°	●	●			
	TT32^{R/L} 5501	G,PT W	-	28-11	24-10	0.1			55°	●	●			
5502	G,PT W	-	14-11	14-10	0.2			55°	●	●				
	TT43ER 100M	M	1.00	-		0.12	0.8			60°	●	J38		
	125M	M	1.25	-		0.15	0.9			60°	●			
	150M	M	1.50	-		0.19	1.0			60°	●			
	200M	M	2.00	-		0.25	1.7			60°	●			
	TT43^{R/L} 6001	M UN	1.0-3.5	-	24-8	0.1				60°	●	KTT^{R/L}...-22	J37	
	6002	M UN	1.5-3.5	-	16-8	0.2				60°	●			
	6003	M UN	2.5-3.5	-	11-8	0.3				60°	●			
	6004	M UN	3.0-3.5	-	8	0.4				60°	●			
	TT43^{R/L} 5501	G,PT W	-	28-11	24-7	0.1				55°	●			
	5502	G,PT W	-	14-11	16-7	0.2				55°	●			
	5503	G,PT W	-	11	10-7	0.3				55°	●			
5504	G,PT W	-	8-7		0.4				55°	●				

For recommended cutting conditions, see page **J29**

Applicable Thread	M: Metric	R, Rc(PT), (BSPT): Tapered Pipe
	UN: Unified	W: Whitworth
	UNF: Unified Fine Thread	NPT: American National Tapered Pipe
	G (PF): Parallel Pipe	Tr: 30°Trapezoidal

PR930 / PR1115 (Threading) are sold in 10 piece boxes.

Inserts are sold in 10 piece boxes.

● : Std. Item □ : Check Availability
R : Std. Item (R-hand Only) L : Std. Item (L-hand Only)