

**KGD-S** (Straight : 0°, Separate Type)

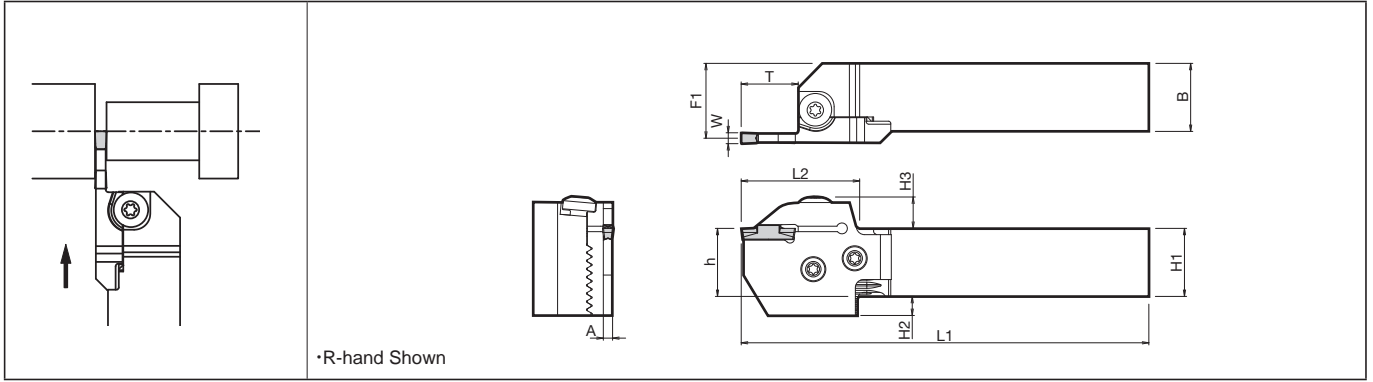

● Toolholder Dimensions (Toolholder+Blade)

Shank Angle	Width (mm)	Available Grooving Depth (mm)	Assembly Number (Standard Stock Number)	Std.		Description ● G28	Blade Description ● G28	Dimension(mm)										Width W (mm)										
				R	L			H1=h	H2	H3	B	L1	L2	L3	F1	A	T	MIN	MAX									
0°	2	17	KGD <sup>R/L</sup> 2020X-2T17S	●	●	KGD <sup>R/L</sup> 2020-C	KGD <sup>R/L</sup> -2T17-C	20	12	11.6	20	122	39.9								23.4	1.7	17	2.0	3.0			
			2525X-2T17S	●	●	KGD <sup>R/L</sup> 2525-C		25	7		25	147									28.4							
	3	10	KGD <sup>R/L</sup> 2020X-3T10S	●	●	KGD <sup>R/L</sup> 2020-C	KGD <sup>R/L</sup> -3T10-C	20	12	20	115	32.9																
			2525X-3T10S	●	●	KGD <sup>R/L</sup> 2525-C		25	7	25	140															28.0		
			3232X-3T10S	●	●	KGD <sup>R/L</sup> 3232-C		32	-	32	160															33.0		
		20	KGD <sup>R/L</sup> 2020X-3T20S	●	●	KGD <sup>R/L</sup> 2020-C	KGD <sup>R/L</sup> -3T20-C	20	12	20	125	42.9																
			2525X-3T20S	●	●	KGD <sup>R/L</sup> 2525-C		25	7	25	150																28.0	
			3232X-3T20S	●	●	KGD <sup>R/L</sup> 3232-C		32	-	32	170																33.0	
	4	10	KGD <sup>R/L</sup> 2020X-4T10S	●	●	KGD <sup>R/L</sup> 2020-C	KGD <sup>R/L</sup> -4T10-C	20	12	20	115	32.9																
			2525X-4T10S	●	●	KGD <sup>R/L</sup> 2525-C		25	7	25	140																27.5	
			3232X-4T10S	●	●	KGD <sup>R/L</sup> 3232-C		32	-	32	160																32.5	
		20	KGD <sup>R/L</sup> 2020X-4T20S	●	●	KGD <sup>R/L</sup> 2020-C	KGD <sup>R/L</sup> -4T20-C	20	12	20	125	42.9																
			2525X-4T20S	●	●	KGD <sup>R/L</sup> 2525-C		25	7	25	150																27.5	
			3232X-4T20S	●	●	KGD <sup>R/L</sup> 3232-C		32	-	32	170																32.5	
		25	KGD <sup>R/L</sup> 2020X-4T25S	●	●	KGD <sup>R/L</sup> 2020-C	KGD <sup>R/L</sup> -4T25-C	20	12	20	130	47.9																
			2525X-4T25S	●	●	KGD <sup>R/L</sup> 2525-C		25	7	25	155																27.5	
			3232X-4T25S	●	●	KGD <sup>R/L</sup> 3232-C		32	-	32	175																32.5	
		5	10	KGD <sup>R/L</sup> 2020X-5T10S	●	●	KGD <sup>R/L</sup> 2020-C	KGD <sup>R/L</sup> -5T10-C	20	12	20	115	32.9															
				2525X-5T10S	●	●	KGD <sup>R/L</sup> 2525-C		25	7	25	140																27.0
				3232X-5T10S	●	●	KGD <sup>R/L</sup> 3232-C		32	-	32	160																32.0
	25		KGD <sup>R/L</sup> 2020X-5T25S	●	●	KGD <sup>R/L</sup> 2020-C	KGD <sup>R/L</sup> -5T25-C	20	12	20	130	47.9																
			2525X-5T25S	●	●	KGD <sup>R/L</sup> 2525-C		25	7	25	155																27.0	
			3232X-5T25S	●	●	KGD <sup>R/L</sup> 3232-C		32	-	32	175																32.0	

Note) 1. In case of normal mounting position, the toolholder body may interfere with the tool presetter.

Recommended Cutting Conditions ● H13

2. Toolholder description and blade description are printed on the toolholder body. (Unit description is not indicated.)

KGD-S : R-hand Blade for R-hand Toolholder, L-hand Blade for L-hand Toolholder.

Combination of the optional toolholder (KGD..-C) and blade (KGD..T.-C) (both separately sold) can make up the corresponding assembly part.

Make sure of the "hand of toolholder" and "hand of blade".

3. Dimension T: Maximum depth to which processing can be made. (If the dimension T is 20 mm or more, the maximum depth of groove made by the 2-edge insert will be 18 mm.)

4. Recommended tightening torque of clamp bolt for insert: 6.5N·m (Groove width 2 - 6 mm)

