

◆ Selection of Insert & Toolholder (Face Grooving)

● Case of KGMM

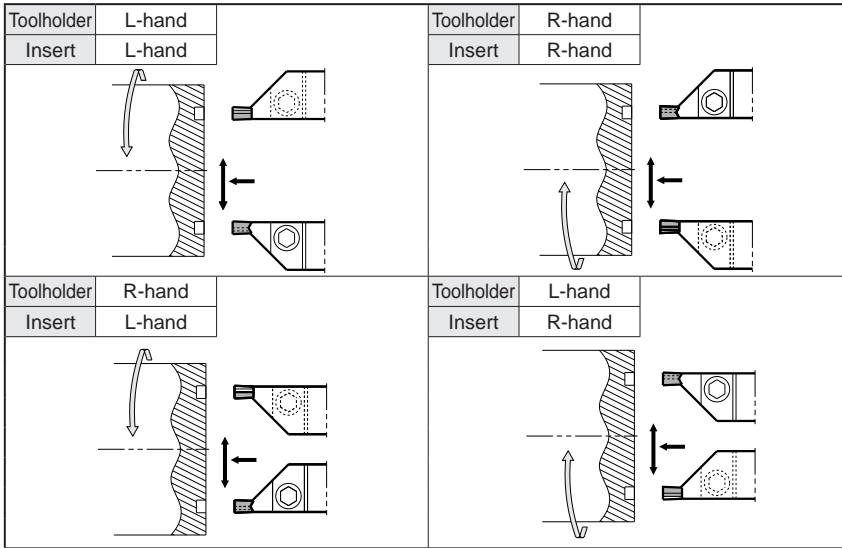

● Case of KGMS

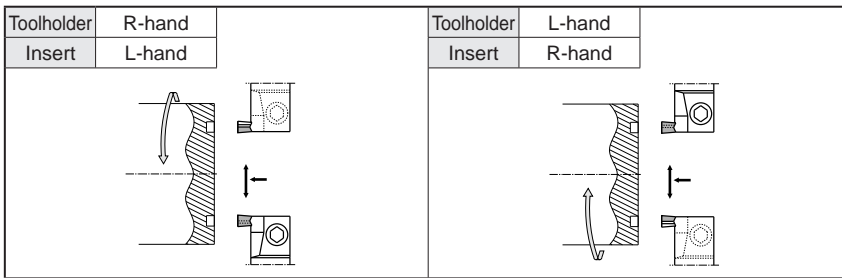

■ KGMU (External Undercutting Toolholder)

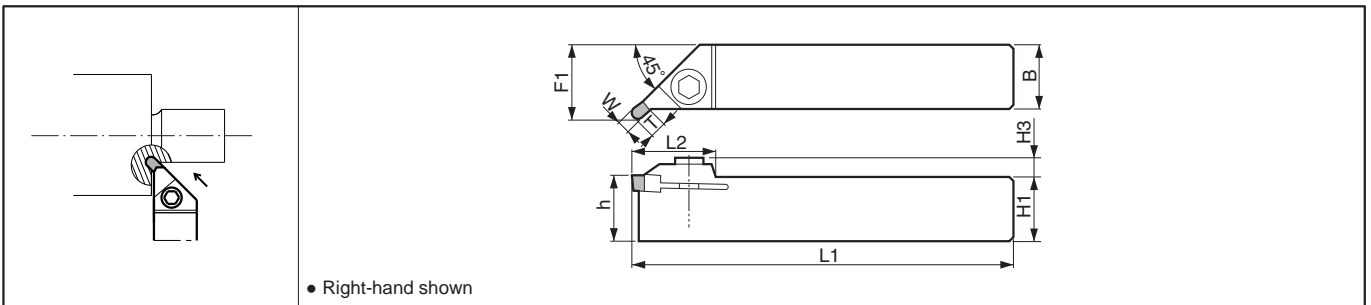

● Toolholder Dimensions

Description	Std.	Dimension (mm)										Edge Width W (mm)		Spare Parts	
		R	L	H1=h	H3	B	L1	L2	F1	T	MIN.	MAX.	Screw	Wrench	
KGMU ^{R/L} 2020K 2525M	●●	20	6	20	125	28.5	23.6	4.8			3.0	5.0	HH5X16	LW-4	
	●●	25		25	150	28.5	28.6			(6.0)		HH5X25			

• Dimension T shows the distance from the Toolholder to the cutting edge. See the table below for the available Grooving Depth.

Dimension F1 shows at GMM5020-RU. () indicates external grooving inserts when installed.

● Applicable Insert

Applications	Undercutting		
Ref. Page	G32		
Shape			
Toolholder			
KGMU ^{R/L} 2020K 2525M	GMG3020..RU GMG4020..RU GMG5020..RU		

• External grooving inserts (grooving width 3mm~6mm) will be attached. (In case of using GMG○○20-○○, GMM○○20-○○○○, GMN○ insert)

◆ Undercut Depth t

Description	Undercut Depth	
	t (mm)	ap (mm)
GMG3020-15RU	3.5	1.8
GMG4020-20RU	4.0	1.9
GMG5020-25RU	4.5	2.1

* In case of undercutting for the diameter over 100mm, external grooving inserts GMG ○○ 20-○○, GMM ○○ 20-○○○○, GMN ○ are also available.

● : Std. Item □ : Check Availability

