

# Toolholders for Grooving and Cut-off

## ● Toolholder

### KGD-S (0° separate type)

Shape of 0° type R-hand Shown	Description	Std.		Dimension		
		R	L	L	B	H1
	KGDR/L 2020-C	●	●	104	20	20
	2525-C	●	●	129	25	25
	3232-C	●	●	149	32	32

## ● Spare Parts (Common with separate types)

\* The parts are included in the toolholder.

Unit Description	Spare Parts		
	Clamp Bolt (for Insert Clamp)	Fixing bolt (for blade)	Wrench
KGDR/L.....S	BH6X10TR 	SB-60120TR 	LTW-25 

## ■ Setting the blade (Separate type toolholder)

1. Use compressed air or other measures to remove chips and dust from the serration part (see Fig. 4).
2. Mate and fit the serrations of the blade and toolholder, and also fit the blade end to the toolholder.
3. Tighten the blade fixing screws at an appropriate torque (Recommended tightening torque: 8N·m). You can tighten them in any order.
4. Set the insert after setting the blade.

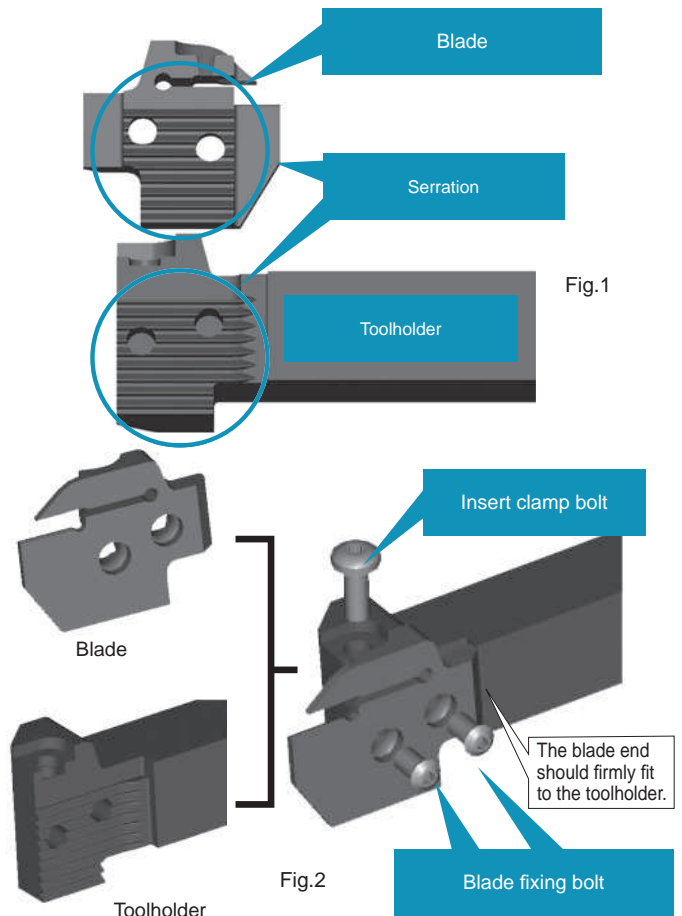

G



### KGDS-S (90° separate type)

Shape of 90° type R-hand Shown	Description	Std.		Dimension		
		R	L	L	B	H1
	KGDSR/L 2020-C	●	●	122	20	20
	2525-C	●	●	147	25	25

## ● Blade

Shape of Blade R-hand Shown	Blade Description	Std.		Dimension		
		R	L	L	T	A
	KGDR/L -2T17-C	●	●	51.2	17.2	1.7
	-3T10-C	●	●	44.2	10.2	2.4
	-3T20-C	●	●	53.2	20.2	
	-4T10-C	●	●	44.2	10.2	3.4
	-4T20-C	●	●	54.2	20.2	
	-4T25-C	●	●	59.2	25.2	4.4
	-5T10-C	●	●	44.2	10.2	
	-5T25-C	●	●	59.2	25.2	

## ■ Separate type Toolholder Identification

### System and Their Setting to Lathe

- Firmly fit the lower jaw to the tool post of the lathe.

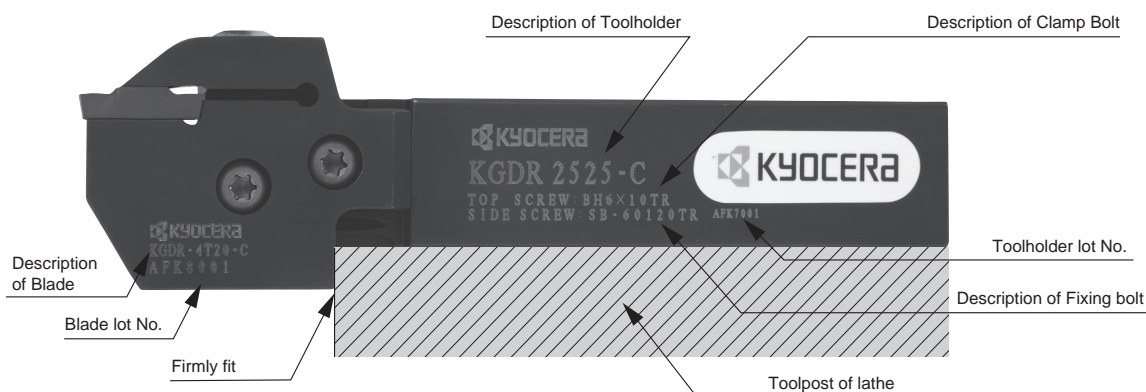

● : Std. Item