

Grooving

G1~G96



G

Summary of External, Internal and Face Grooving G2~G9

External Grooving

G10~G40



KGBA / KGBAS		G13
KGB / KGBS → Will be switched to KGBA / KGBAS		G15
KTGF-F / KTGF		G16
S...KTGF	Sleeve holder	G16
KTG → Will be switched to KGBA		G18
KN91		G19
KGH / KGHS		G20
KGA		G21
KGD (Integral Type)		G26
KGD-S (0° Separate Type)		G27
KGDS-S (90° Separate Type)		G27
KGM (For automatic lathe)		G36
KGM / KGM-T		G36
KGMM / KGMS		G38
KGMU		G39
KGMW (For Aluminum Wheel)		G40

Internal Grooving

G41~G60

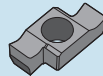

VNG	System Tip-bars	G43
HPG	2-Edge Tip-Bar	G44
PSFG-S → Will be switched to HPG	Tip-Bars	G44
SIGE-EH / SIGE-WH / SIGE-WH-90		G48
GIV / GIV-E / GIV-W		G52
KIGBA		G55
KITG → Will be switched to KIGBA		G56
KIGH		G57
KIGM-V		G58
KIGM-8 / KIGMU-8		G59
KGIA		G60

Face Grooving

G61~G88

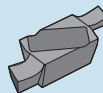

VNFG	System Tip-bars	G64
HPFG	2-Edge Tip-Bar	G65
PSFG-S → Will be switched to HPFG	Tip-Bars	G65
TWFG / TWFGT	Twin Bars	G66
KGDF (Separate Type)		G70
GFVS-AA / GFVT-AA		G76
GFV		G78
GFVS / GFVT		G80
KFMS		G84
KFMS-8		G86
KFTB-S		G87
GIFV (Boring Bar Type)		G88

Technical Information

G89~G96



Recommended Cutting Conditions	G89
Guide for Grooving	G94

Alternative Toolholder Reference Table for Grooving Toolholder G96

