

S...PWLN06 (Boring / Internal Facing)

Max. Overhang Length L/D=-3

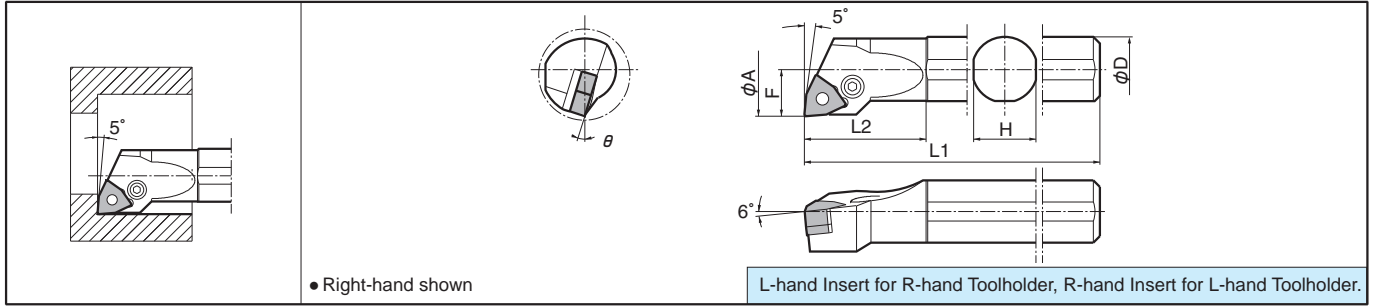

A...PWLN06 Twin-Hole Bar (Boring / Internal Facing: with Coolant Hole)

Max. Overhang Length L/D=-3

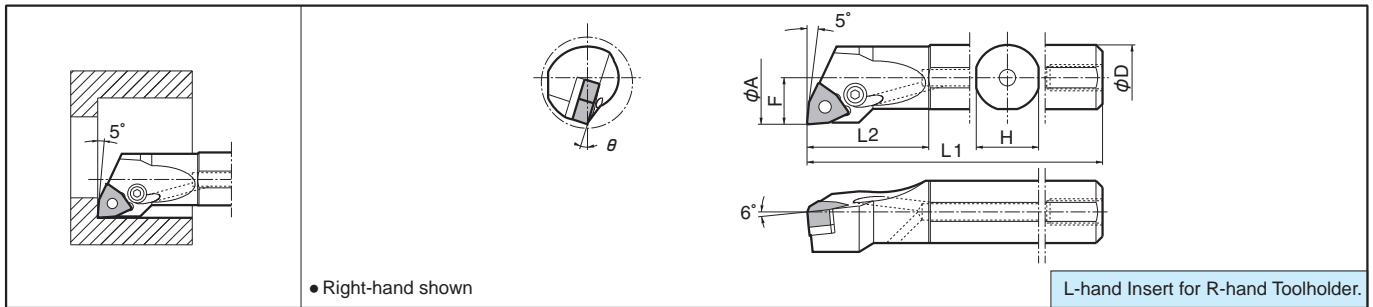

Toolholder Dimensions

Description	(Previous Description)	Std.		Min. Bore Dia.	Dimension (mm)					θ	Standard Corner-R (r)	Spare Parts					
		R	L		φA	φD	H	L1	L2			F	Lever	Lock Screw	Shim	Shim Pin	Punch
		S16M-PWLN ^{R/L} 06-20	PWLN ^{R/L} 2016B-06	●	●	20	16	15	150	34	11	16°	0.8				
S20Q-PWLN ^{R/L} 06-27	PWLN ^{R/L} 2720B-06	●	●	27	20	19	180	37	14.2	17°	0.8						
S25R-PWLN ^{R/L} 06-32	3225B-06	●	●	32	25	24	200	42	15.7	15°							
A16M-PWLN ^{R/L} 06-20	PWLN ^{R/L} 2016B-06H	●		20	16	15	150	34	11	16°	0.8						
A20Q-PWLN ^{R/L} 06-27	PWLN ^{R/L} 2720B-06H	●		27	20	19	180	37	14.2	17°	0.8						
A25R-PWLN ^{R/L} 06-32	3225B-06H	●		32	25	24	200	42	15.7	15°							

Applicable Inserts

Applications	Finishing	Finishing-Medium	Medium-Roughing	Finishing	Medium						
Ref. Page	B38	B38	B38	B40	B40						
Insert	GP	HQ	GS	^{R/L} -S	^{R/L}						
Toolholder											
---PWLN ^{R/L} 06---	WNMG0604..	WNMG0604..	WNMG0604..	WNGG0604..	WNGG0604..						

For recommended cutting conditions, see page [F82-F83](#)

Applicable Coolant Sleeve / Joint

Toolholder	Applicable Coolant Sleeve	Applicable Coolant Joint
A16M-PWLN ^{R/L} 06-20	SHC1640-70, SHC1650-95	SJS-8
A20M-PWLN ^{R/L} 06-27	SHC2040-70, SHC2050-95	
A25R-PWLN ^{R/L} 06-32	SHC2540-70, SHC2550-95	

For Coolant Sleeve, Coolant Joint, see [F78-F79](#).