

Boring Bar [DC Insert]

S...SDUC-E Excellent Bar (Copying)

Max. Overhang Length L/D≈5

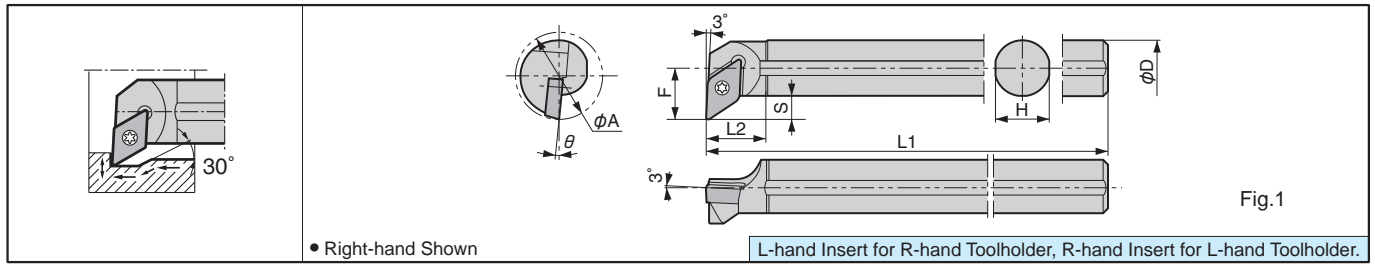

S...SDUC Steel Bar (Copying)

Max. Overhang Length L/D≈3

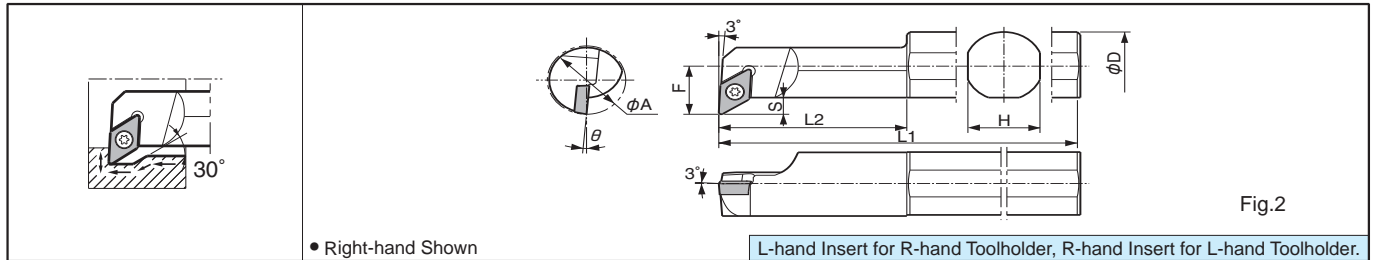

C...SDUC Carbide Shank Bar (Copying)

Max. Overhang Length L/D≈7

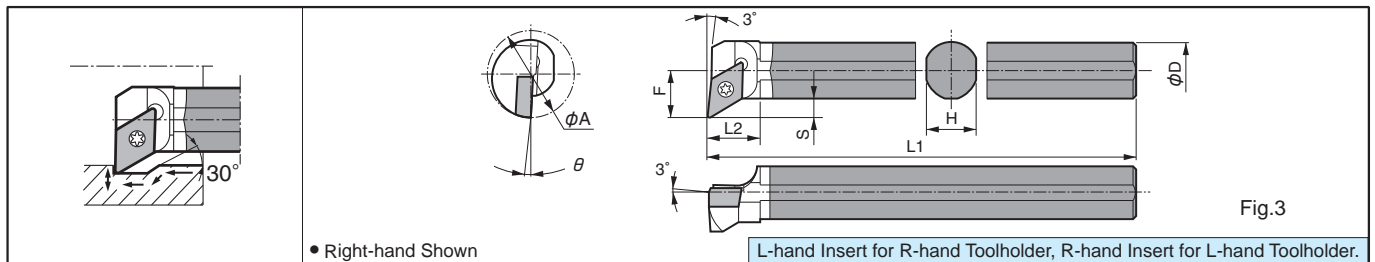

• Toolholder Dimensions [Will be switched to Dynamic Bar, see **F85-F88** (Alternative Toolholder Reference Table for Boring Bar)].

Description	(Previous Description)	Std.		Min. Bore Dia.	Dimension (mm)										Standard Corner-R. (R)	Drawing	Spare Parts					
		R	L		ϕA	ϕD	H	L1	L2	L3	L4	F	S	θ			Clamp Screw	Wrench				
S10M-SDUC ^ϕ .07-14E	SDUC ^ϕ . 1410B-07E	<input type="checkbox"/>	<input type="checkbox"/>	14	10	9	150	18						8.3		5°	0.4	Fig.1	SB-2560TR	FT-8		
S12M-SDUC ^ϕ .07-16E	1612B-07E	<input type="checkbox"/>	<input type="checkbox"/>	16	12	11	150	20					9.3	3.3								
S16Q-SDUC ^ϕ .07-20E	2016B-07E	<input type="checkbox"/>	<input type="checkbox"/>	20	16	15	180	20					11.3									
S16Q-SDUC ^ϕ .11-25E	2516B-11E	<input type="checkbox"/>	<input type="checkbox"/>	25	16	15	180	21					14.1	6.1	5°	0.8	Fig.2	SB-4085TR	FT-15			
S20Q-SDUC ^ϕ .11-32E	3220B-11E	<input type="checkbox"/>	<input type="checkbox"/>	32	20	19	220	22					16.1									
S16Q-SDUC ^ϕ .07-14	SDUC ^ϕ . 1416B-07	<input type="checkbox"/>	<input type="checkbox"/>	14	16	14	180	30					10.4	4.4	5°	0.4	Fig.2	SB-2560TR	FT-8			
S16Q-SDUC ^ϕ .07-16	1616B-07	<input type="checkbox"/>	<input type="checkbox"/>	16	16	14	180	35					11.4									
S20R-SDUC ^ϕ .11-20	2020B-11	<input type="checkbox"/>	<input type="checkbox"/>	20	20	18	200	50					15.1	6.1	5°	0.8						
S25X-SDUC ^ϕ .11-25	2525B-11	<input type="checkbox"/>	<input type="checkbox"/>	25	25	23	220	60					17.6									
C10N-SDUC ^ϕ .07-14	SDUC ^ϕ . 1410B-07W	<input type="checkbox"/>	<input type="checkbox"/>	14	10	9	160	11					8.2		5°	0.4	Fig.3	SB-2560TR	FT-8			
C12Q-SDUC ^ϕ .07-16	1612B-07W	<input type="checkbox"/>	<input type="checkbox"/>	16	12	11	180	12					9.2	3.3								
C12Q-SDUC ^ϕ .11-20	2012B-11W	<input type="checkbox"/>	<input type="checkbox"/>	20	12	11	180	15					12.3									
C16X-SDUC ^ϕ .11-25	2516B-11W	<input type="checkbox"/>	<input type="checkbox"/>	25	16	15	220	16					14.3	6.1	5°	0.8						
C20S-SDUC ^ϕ .11-32	3220B-11W	<input type="checkbox"/>	<input type="checkbox"/>	32	20	19	250	17					16.3									

• Applicable Inserts

Applications	Minute ap	Finishing	Finishing-Medium	Finishing-Medium	Medium	Medium-Roughing	Finishing	Finishing / Precision	Low Feed	Low Feed / Precision
Ref. Page	B52	B52	B53	B53	B54	B53	B55	B55	B56	B56
Insert	CF	GP	GK	HQ	FN-Z	Standard	ϕ/-F	ϕ/-FSF	(E / F) ϕ/-U	Fϕ/-USF
Toolholder										
Applications	Low Feed	Low Feed / Precision	Soft Steel Finishing	Soft Steel Finishing-Medium	Stainless Steel	Cast Iron	Non-ferrous Metals	Non-ferrous Metals	Non-ferrous Metals	Hard Materials
Ref. Page	B57	B57	B54	B54	B54	B57	B57	B57	C19	C11
Insert	(E / F) ϕ/-J	Fϕ/-JSF	XP	XQ	MQ	Without Chipbreaker	AH	ϕ/-A3	PCD	CBN
Toolholder										
Applications	-	-	DCMT0702..	-	DCMT0702..	DCGW0702..	-	-	DCMT0702..	DCMW0702..
Ref. Page	-	-	DCMT0702..	-	DCMT0702..	DCGW0702..	-	-	DCMT0702..	DCMW0702..
Applications	-	-	DCMT11T3..	-	DCMT11T3..	DCGW11T3..	-	-	DCMT11T3..	DCMW11T3..
Ref. Page	-	-	DCMT11T3..	-	DCMT11T3..	DCGW11T3..	-	-	DCMT11T3..	DCMW11T3..

For recommended cutting conditions, see page **F82-F83**