

SVNS-XN Square Shank (L-shape)

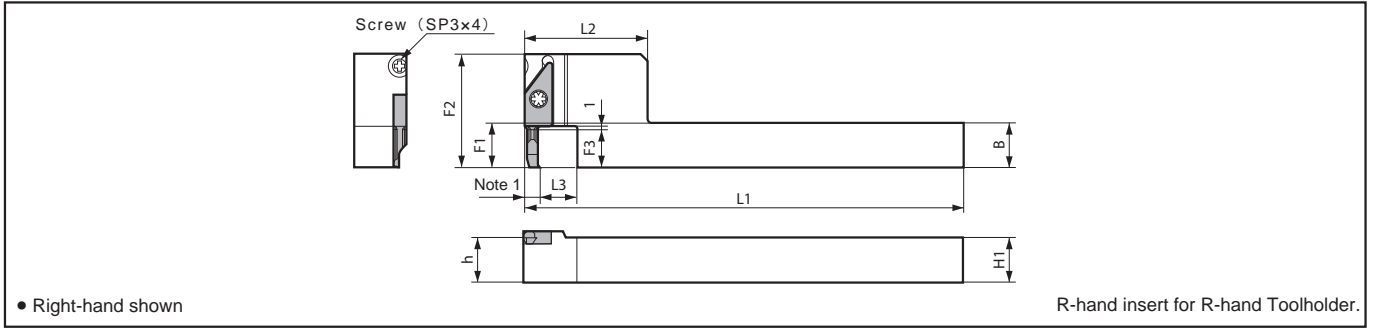

Note 1 : The dimension of Note 1 is same size as the applicable insert (VNBX F20) F2 dimension.

● Toolholder Dimensions (L-shape square shank applicable to gang tool post)

Description	Std.	Dimension (mm)									Spare Parts			*Applicable Inserts F20
		H1-h	B	L1	L2	L3	F1	F2	F3	Clamp Screw	Wrench	Screw		
SVNSR 1010K-12-06XN	●	10	10	125			10	29	6		SB-3080TR	LTW-10S	SP3×4	(VNBXR02..)
1010K-12-11XN	●							33	11					(VNBXR0011..)
1212M-12-06XN	●					10	29	6						(VNBXR02..)
1212M-12-11XN	●	12	12			12	33	11						(VNBXR0011..)
1212M-12-20XN	●			150			42	20						(VNBXR0420..)
1616M-12-06XN	●						29	6						(VNBXR02..)
1616M-12-11XN	●	16	16			16	33	11						(VNBXR0011..)
1616M-12-20XN	●						42	20						(VNBXR0420..)

* All System Tip-Bar Inserts are used with a SVNS-XN Toolholder, however, When setting the cutting edge at the face level of the toolholder as shown in Fig., use the insert shown in ().

S...SVN-XN (Round Shank: Standard type)

S...SVN-SXN (Round Shank: Straight type)

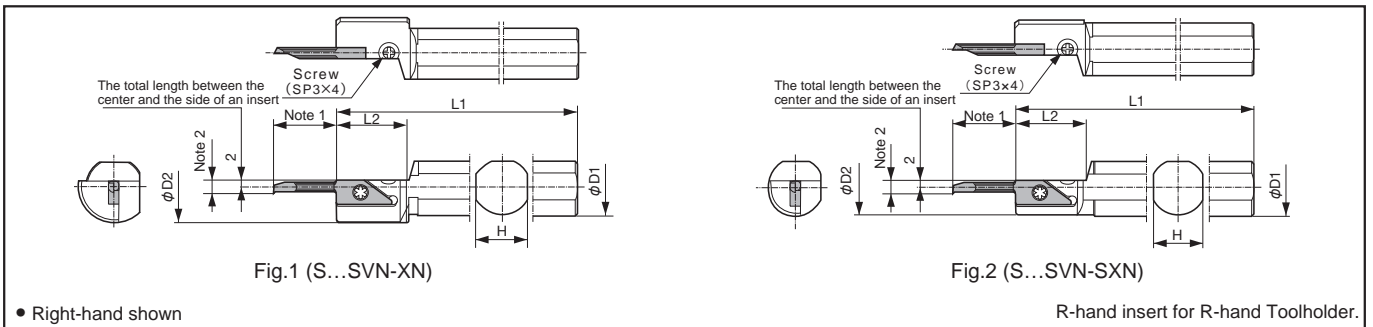

Note 1 : The dimension of Note 1 shows the applicable insert (VNBX F20) L2 dimension + 1 mm.

Note 2 : The dimension of Note 2 is the same as the applicable insert (VNBX F20) F2 dimension.

● Toolholder Dimensions (Holder center axis core and insert center are coaxial type)

Description	Std.	Dimension (mm)						Drawing	Spare Parts			Applicable Inserts F20
		∅D1	∅D2	H	L1	L2	Clamp Screw		Wrench	Screw		
S12F -SVNR12XN	●	12		11	80		Fig.1	SB-3080TR	FT-10	SP3×4	VNBXR...	
S14G -SVNR12XN	●	14	20	13	90							
S15H -SVNR12XN	□	15.875		15	100	23						
S16H -SVNR12XN	●	16		17	160							
S19H -SVNR12XN	●	19.05	24	18	100	24						
S19N -SVNR12XN	●	20		18	100							
S20H -SVNR12XN	●	20		18	100							
S25H -SVNR12XN	●	25.4	30	23	180							
S25Q -SVNR12XN	●	25.4	30	23	180							
S19H -SVNR12SXN	●	19.05	18.5	17	100	23	Fig.2	SB-3080TR	FT-10	SP3×4	VNBXR...	
S20H -SVNR12SXN	●	20	19.5	18	100							
S22K -SVNR12SXN	●	22	21.5	20	125							
S25.0G -SVNR12SXN	●	25	24.5	23	90							

* Reminder of applicable insert.

● : Std. Item □ : Check Availability

