

Magic Drill DRZ

Metric-Inch (3xD)

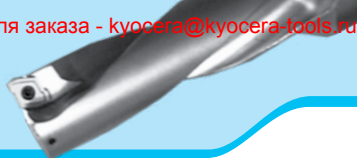

DRZ (Drilling Depth : 3 x D) Metric Dimension with Inch Shank

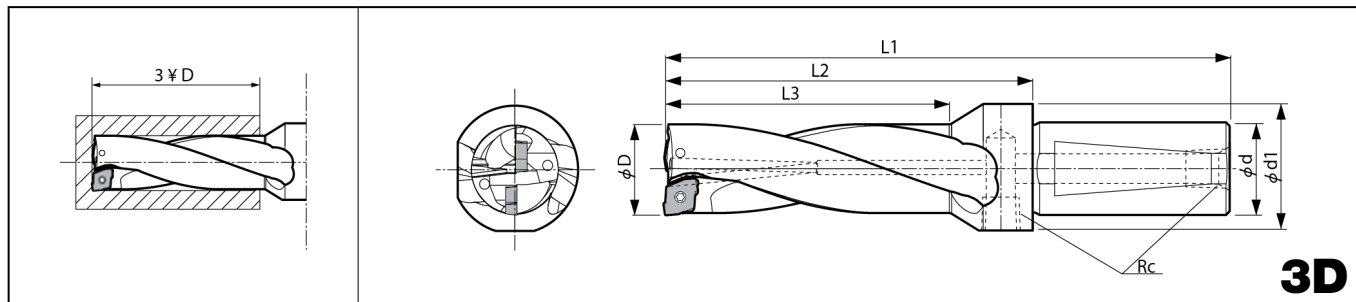

3D

Toolholder Dimensions

Description	Stock	No. of Insert	Dimension (inch)						Max. Offset (Radial)	Spare Parts			Applicable Inserts ● Page 6		
			ØD	L1	L2	L3	Ød	Ød1		Rc	Insert Screw	Wrench		Plug	
S075 -DRZ1339-05G	●	2	0.512 (13.0mm)	4.27	2.58	1.54	0.75	1.06	1/8 NPT	+ 0.020	SB-2045TR	FT-6	GP-1N	ZCMT050203 ZCMT050203SP ZCMT050203SU	
-DRZ135405-05G	●		0.531 (13.5mm)	4.27	2.58	1.59									+ 0.020
-DRZ1442-05G	●		0.551 (14.0mm)	4.42	2.72	1.65									+ 0.020
-DRZ145435-05G	●		0.571 (14.5mm)	4.42	2.72	1.71									+ 0.020
-DRZ1545-05G	●		0.591 (15.0mm)	4.52	2.83	1.77									+ 0.020
-DRZ155465-05G	●		0.610 (15.5mm)	4.52	2.83	1.83									+ 0.020
S100 -DRZ1648-06G	●	2	0.630 (16.0mm)	5.15	3.02	1.89	1.00	1.26	1/8 NPT	+ 0.043	SB-2260TR	DT-7	GP-1N	ZCMT06T204 ZCMT06T204SP ZCMT06T204SU	
-DRZ165495-06G	●		0.650 (16.5mm)	5.15	3.02	1.95									+ 0.035
-DRZ1751-06G	●		0.669 (17.0mm)	5.23	3.10	2.01									+ 0.031
-DRZ1854-06G	●		0.709 (18.0mm)	5.36	3.23	2.13									+ 0.024
-DRZ185555-06G	●		0.728 (18.5mm)	5.36	3.23	2.19									+ 0.024
-DRZ1957-06G	●		0.748 (19.0mm)	5.48	3.35	2.24									+ 0.020
-DRZ195585-06G	●		0.768 (19.5mm)	5.48	3.35	2.30									+ 0.020
-DRZ2060-06G	●		0.787 (20.0mm)	5.61	3.49	2.36									+ 0.020
-DRZ2163-06G	●		0.827 (21.0mm)	5.76	3.64	2.48									+ 0.008
-DRZ215645-08G	●		0.846 (21.5mm)	5.77	3.65	2.54									1.00
-DRZ2266-08G	●	0.866 (22.0mm)	5.77	3.65	2.60	+ 0.063									
-DRZ225675-08G	●	0.866 (22.0mm)	5.77	3.65	2.66	+ 0.055									
-DRZ2369-08G	●	0.906 (23.0mm)	5.89	3.76	2.72	+ 0.051									
-DRZ2472-08G	●	0.945 (24.0mm)	6.00	3.87	2.84	+ 0.043									
-DRZ2575-08G	●	0.984 (25.0mm)	6.11	3.98	2.95	+ 0.031									
-DRZ2678-08G	●	1.024 (26.0mm)	6.23	4.10	3.07	+ 0.024									

● When offset machining, reduce feed rate to .003ipr or less
● See ● Page 77 for Adjustable Sleeve ASL.

Magic Drill DRZ
Drilling