

MOF45 Face Mill (05 type / 07 type)

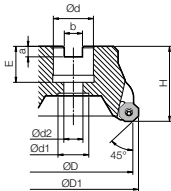

Fig.1

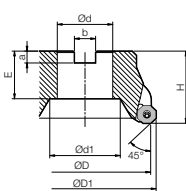

Fig.2

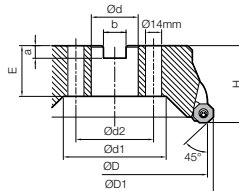

Fig.3

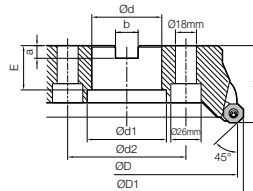

Fig.4

Rake Angle (°)	
A.R.	R.R.
+15°	-5°

Toolholder Dimensions

Part Number			Stock	No. of Inserts	Dimensions (mm)								Drawing	Weight (kg)	Applicable Inserts 🔄 B21	
					ØD	ØD1	Ød	Ød1	Ød2	H	E	a				b
Inch Bore Dia.	MOF	45080R-05-6T	○	6	80	89	1.000"	20	13.0	50	1.024"	0.236"	0.375"	Fig.1	1.1	OFMT05 Type
		45100R-05-7T	○	7	100	109	1.250"	45	-	50	1.260"	0.315"	0.500"	Fig.2	1.8	
		45125R-05-8T	○	8	125	134	1.500"	55	-	63	1.496"	0.394"	0.625"	Fig.2	3.7	
		45160R-05-10T	○	10	160	169	2.000"	88	-	63	1.496"	0.433"	0.750"	Fig.2	5.1	
		45200R-05-12T	○	12	200	209	1.875"	68	101.6	63	1.496"	0.551"	1.000"	Fig.4	8.0	
	MOF	45080R-07-5T	○	5	80	92	1.000"	20	13.0	50	1.024"	0.236"	0.375"	Fig.1	1.2	OFMT07 Type
		45100R-07-6T	○	6	100	112	1.250"	45	-	50	1.260"	0.315"	0.500"	Fig.2	1.8	
		45125R-07-8T	○	8	125	137	1.500"	55	-	63	1.496"	0.394"	0.625"	Fig.2	3.7	
		45160R-07-10T	○	10	160	172	2.000"	88	-	63	1.496"	0.433"	0.750"	Fig.2	5.1	
		45200R-07-12T	○	12	200	212	1.875"	68	101.6	63	1.496"	0.551"	1.000"	Fig.4	8.0	
Metric Bore Dia.	MOF	45040R-05-3T-M	○	3	40	49	16	13.5	8.5	40	19	5.6	8.4	Fig.1	0.3	OFMT05 Type
		45050R-05-4T-M	○	4	50	59	22	17	11.0	40	21	6.3	10.4	Fig.1	0.4	
		45063R-05-5T-M	○	5	63	72	22	17	11.0	40	21	6.3	10.4	Fig.1	0.6	
		45080R-05-6T-M	○	6	80	89	27	20	13.0	50	24	7.0	12.4	Fig.1	1.1	
		45100R-05-7T-M	○	7	100	109	32	45	-	50	32	8.0	14.4	Fig.2	1.8	
		45125R-05-8T-M	○	8	125	134	40	55	-	63	33	9.0	16.4	Fig.2	3.7	
		45160R-05-10T-M	○	10	160	169	40	88	66.7	63	30	9.0	16.4	Fig.3	5.1	
	45200R-05-12T-M	○	12	200	209	60	68	101.6	63	38	14.0	25.7	Fig.4	8.0		
	MOF	45063R-07-4T-M	○	4	63	75	22	17	11.0	40	21	6.3	10.4	Fig.1	0.6	OFMT07 Type
		45080R-07-5T-M	○	5	80	92	27	20	13.0	50	24	7.0	12.4	Fig.1	1.2	
		45100R-07-6T-M	○	6	100	112	32	45	-	50	32	8.0	14.4	Fig.2	1.9	
		45125R-07-8T-M	○	8	125	137	40	55	-	63	33	9.0	16.4	Fig.2	3.7	
45160R-07-10T-M		○	10	160	172	40	88	66.7	63	30	9.0	16.4	Fig.3	5.1		
45200R-07-12T-M	○	12	200	212	60	68	101.6	63	38	14.0	25.7	Fig.4	8.0			

Spare Parts

Part Number	Spare Parts		
	① Clamp Screw	② Wrench	Arbor Bolt
MOF 45080R-05-6T 45100R-05-7T 45125R-05-8T 45160R-05-10T 45200R-05-12T	SB-4082TPR	DTP-15	HH12X35M
	SB-4082TPR	DTP-15	-
	SB-50120TRS	DTP-15	HH12X35M
	SB-50120TRS	DTP-15	-
	SB-4082TPR	DTP-15	HH8X25
MOF 45040R-05-3T-M 45050R-05-4T-M 45063R-05-5T-M 45080R-05-6T-M 45100R-05-7T-M 45125R-05-8T-M 45160R-05-10T-M 45200R-05-12T-M	SB-4082TPR	DTP-15	HH10X30M
	SB-4082TPR	DTP-15	HH12X35M
	SB-4082TPR	DTP-15	-
	SB-50120TRS	DTP-15	HH10X30S
	SB-50120TRS	DTP-15	HH12X35M
MOF 45063R-07-4T-M 45080R-07-5T-M 45100R-07-6T-M 45125R-07-8T-M 45160R-07-10T-M 45200R-07-12T-M	SB-50120TRS	DTP-15	-
	SB-50120TRS	DTP-15	-
	SB-50120TRS	DTP-15	-
	SB-50120TRS	DTP-15	-
	SB-50120TRS	DTP-15	-

Max. D.O.C. and Usable Edges

Usable Edges	Max. D.O.C.	
	OFMT05 Type	OFMT07 Type
4 Edges (using 2 edges at the same time)	0.28"	0.39"
8 Edges (using only 1 edge at a time)	0.10"	0.16"

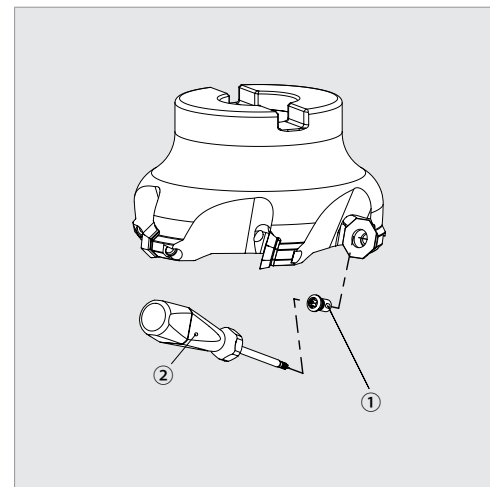

Recommended Cutting Conditions C15