

# PREVIOUS SPARE PART LIST

## MSD45 (Face Mills)

Part Number	Spare Parts				
	① Cartridge	② Clamp Screw	③ Clamp	④ Clamp Screw	Wrench
<b>MSD 45...R</b>	LSD-445R	HH4X16	C20R	TH8X15	TH-4

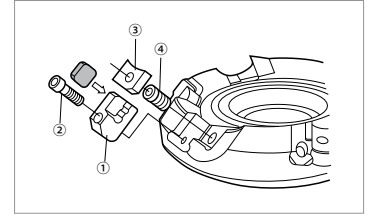

## MSO45-09 (Face Mills)

Part Number	Spare Parts	
	Clamp Screw	Wrench
<b>MSO 45...R-09</b>	SB-3060TR	DT-10

## MSP15 (Face Mills)

Part Number	Spare Parts				
	① Cartridge	② Clamp Screw	③ Clamp	④ Clamp Screw	Wrench
<b>MSD 15...R</b>	LSP-415R	HH4X16	C25R	TH8X15	TH-4

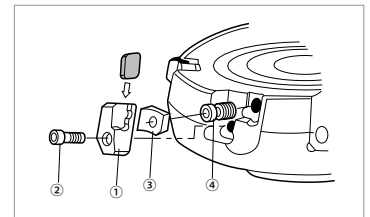

\* Mounting bolt (HH12X35) is included with MSP1580R

## MTE90-SF

Part Number	Spare Parts						
	Cartridge	Clamp	Clamp	Clamp Screw	Adjustment Screw	Wrench	Wrench
<b>MTE 90...-SF</b>	LTE-490SR	C91R (for Insert)	C92R (for Cartridge)	W8X16	SV-60136R	TTC-25	LW-4 (For Adjustment Screw)

## MTE90 (Face Mills)

Part Number	Spare Parts				
	① Cartridge	② Clamp Screw	③ Clamp	④ Clamp Screw	Wrench
<b>MTE 90...R</b>	LTE-490R	HH4X16	C17R	W8X18	TH-4

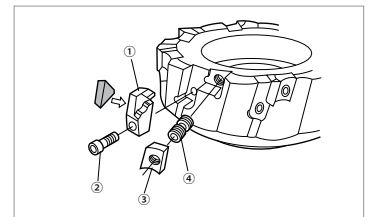

## MSO90-09 (Face Mills)

Part Number	Spare Parts	
	Clamp Screw	Wrench
<b>MSO 90...R-09</b>	SB-3060TR	DT-10

## MEA / MEB

Part Number	Spare Parts	
	Clamp Screw	Wrench
<b>MEA .. -S..(-...)</b>	SB-2560TR	DT-8
<b>MEB .. -S..</b>	SB-4085TR	DT-15

GRADES	<b>A</b>
LINEUP / INSERTS	<b>B</b>
45° / 70° LEAD	<b>C</b>
75° LEAD	<b>D</b>
90° LEAD	<b>E</b>
HIGH FEED	<b>F</b>
MULTI-FUNCTION	<b>G</b>
SLOT MILLS	<b>H</b>
RADIUS / BALL-NOSE	<b>J</b>
OTHER APPLICATIONS	<b>K</b>
TOOL HOLDING	<b>O</b>
<b>SPARE PARTS</b>	<b>P</b>
TECHNICAL	<b>R</b>
INDEX	<b>T</b>