

CAT40

End Mill Toolholders

- Made from 8620 Alloy Steel
- All critical surfaces are precision ground
- Case hardened to 56-58 RC
- Case depth is .03-.04
- Balanced to G2.5 @ 20,000 rpm
- Concentricity is .0001 or less
- Rear thread for pull stud is 5/8-11
- Coolant through capable

CAT40 End Mill Holders

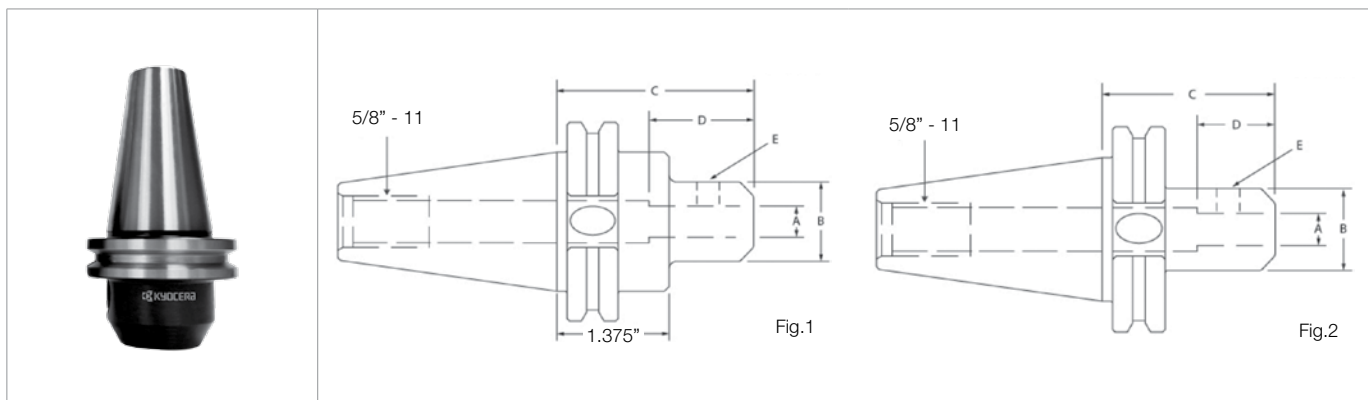

CAT40 Holder Dimensions

Part Number	Stock	Dimensions (in)					
		I.D. (A)	O.D. (B)	Gage Length (C)	Tool Depth (D)	Set Screw (E)	Drawing
KYO-CAT40- EM.500-1.75	●	0.500	1.375	1.750	N/A	7/16-20	2
EM.625-1.75	●	0.625	1.500	1.750	2.100	9/16-18	2
EM.75-1.75	●	0.750	1.750	1.750	2.500	5/8-18	2
EM1.0-1.75	●	1.000	1.750	1.750	2.600	5/8-18	2
EM1.25-2.5	●	1.250	2.500	2.500	2.750	3/4-16	1
EM1.5-4.0	●	1.500	2.620	4.000	3.000	2x - 3/4-16	2*

* This tool holder does not have a safety zone for the tool changer.
Although most machines do not require a safety zone, please be sure to check your machine tool requirements.

GRADES **A**

LINEUP / INSERTS **B**

45° / 70° LEAD **C**

75° LEAD **D**

90° LEAD **E**

HIGH FEED **F**

MULTI-FUNCTION **G**

SLOT MILLS **H**

RADIUS / BALL-NOSE **J**

OTHER APPLICATIONS **K**

TOOL HOLDING **O**

SPARE PARTS **P**

TECHNICAL **R**

INDEX **T**